

Set on Ref. hub. F.S. on object 112 on
line just Run so Aug R
to line through arc 30' E. 111. 23° 38'.
making course S. 89° 23' W
Begin measure at 1/4 cor. Thence as per diagram
S. 89° 23'

14 □ 1 Azimuthal

Tr. A. on 0° 00' F. S. S 89° 23' Read L. to R.

1 N.W. Fence cor	109.00	642 44 275° 00'
2 S.W. " "	140.00	512 36 255. 45'
3 " " " "	117.00	305° 05'
4 " " " "	56.00	359. 00'
5 " " " "	61.00	28° 10'
6 S. " "	83.00	50° 45'
7 N.W. Willow	75.00	272 10'
8 E. Willow line River	72.00	3° 10'
9 E. " " " "	28.00	82° 00'
10 S. " " " "	40.00	59° 35'
11 E. " " " "	71.00	100° 00'
12 " " " "	114.00	114° 00'
13 " " " "	165.00	123° 00'
14 " " " "	226.00	130° 45'
15 " " " "	229.00	87° 45'
16 " " " "	850.00	82° 45'

Continue on □ 2 F.S. on □ 1 > R to □ 3 = 48° 51'

At □ 2 F.S. on □ 1 Azimuthal 75° 40' 00'

1 F.C. sand & Bank	46.	249. 00'
2 " " " "	75.	210° 10'
3 " " " "	115.	200° 20'
4 Bank S. of Sand	33.0	332° 00'

Set on □ 3 F.S. on line a head

measure to end 24 □ 4 53°

Set □ 5 F.S.

" on □ 4 F.S. on □ 5 > L 82° 20' B A

" " A F.S. on □ 5 > L 100° 30' B

" " B " " A > L 103° 49' C

" " C " " B > L 149° 45' D 5 7-15

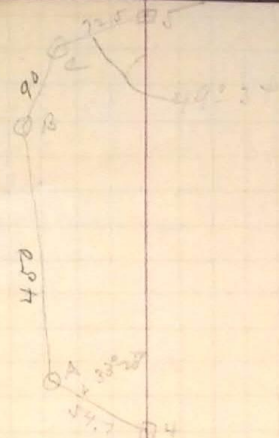

110
228.8
520.
863.8
624.4
1079.2
6 □ 5

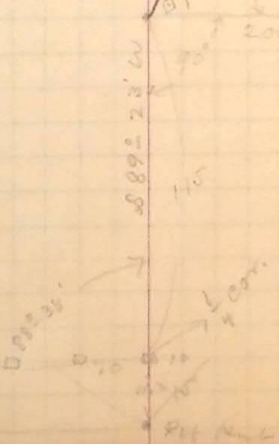
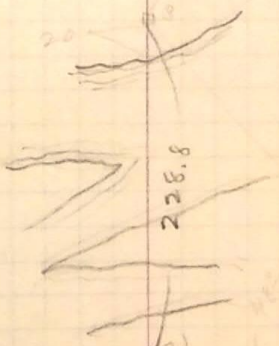

110
500 1/2